

SURFACE MOUNTED "S9 FRAME" WITH OPAL OR PRISMATIC DIFFUSER



- **Frame** has a circular shape and is equipped with turn clips (thermoplastic or galvanized steel) which enable the diffuser to totally enclose the luminaire sides.
- **Normal (or electronic) ballast.**
- **Circular tubular fluorescent lamps** : 22 w , 32 w , 40 w.

DIFFUSER TYPES

OPAL DIFFUSER

O : "BLOWN OPAL" diffuser.



PRISMATIC DIFFUSER

P 1 : " BLOWN PRISMATIC " diffuser incorporating internal pyramidal prisms.



LUMINAIRE TYPES & DIMENSIONS

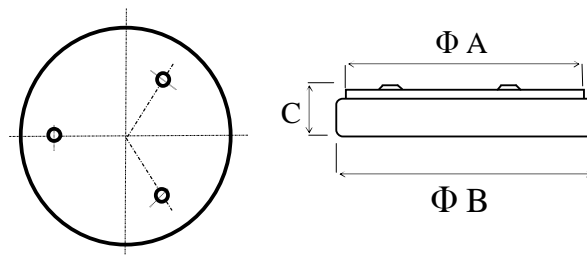

LUMINAIRE TYPE	LAMP (S)	DIMENSIONS		
		A	B	C
1 22 S9	22 w CT	250	280	90
1 32 S9	32 w CT	350	380	90
1 40 S9	40 w CT	455	480	100
1 32/S9	32 w CT	360	380	95
1 40/S9	40 w CT	465	480	100

(add diffuser to the luminaire type).

CT : circular tubular fluorescent lamps

" / " : means bigger frame size